

**Cypress Abbey**  
Pasco County, Florida

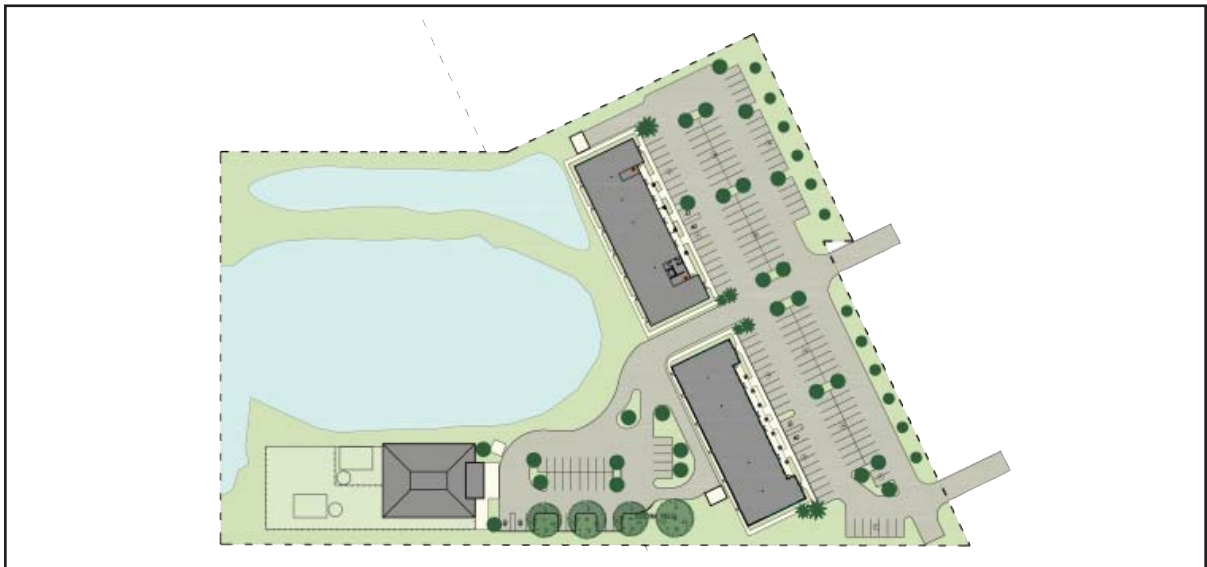

Project: Mixed-Use

Size: 39,900 SF

Special Features: This commercial development includes a two story retail/office building, a single story retail building, and a daycare center. Office tenant spaces on the second floor are accessed by an exterior breezeway. The project will be submitted to the EPA to attain "Designed to Earn the Energy Star" recognition.

Project Details: CDP is providing master planning services as well as complete architectural services for the shell construction.